

# Specification



## JU5500V-3450

JUPITER 5 Series: Two-Platen Servo-Hydraulic



Clamping Unit		JU5500V
Clamping Force	kN	5500
	US Tons	618
Mold Opening Stroke (Min/Max)	mm	1300/750
	in.	51.18/29.53
Minimum Mold Height	mm	350
	in.	13.78
Maximum Mold Height	mm	900
	in.	35.43
Maximum Daylight	mm	1650
	in.	64.96
Distance Between Tie-Bars (HXV)	mm	920x830
	in.	36.22x32.68
Platen Dimensions (HXV)	mm	1280x1260
	in.	50.39x49.61
Ejector Stroke	mm	250
	in.	9.84
Ejector Force	kN	110
	US Tons	12
Maximum Mold Weight*	t	8
	lbs.	17637

# Specification



## JU5500V-3450

JUPITER 5 Series: Two-Platen Servo-Hydraulic

Injection Unit		3450		
Screw & Barrel Designation		A	B	C
Screw Diameter	mm	70	80	85
	in.	2.76	3.15	3.35
Screw L/D Ratio	L/D	22.9	20	19.1
Injection Volume (theoretical)	cm <sup>3</sup>	1423	1859	2099
	cu.in.	86.84	113.44	128.09
Injection Weight (PS)	g	1295	1692	1910
	oz.	45.68	59.68	67.37
Injection Rate (PS)	g/s	402	525	593
	oz./s	14.18	18.52	20.92
Injection Pressure	MPa	208	159	141
	psi	30168	23061	20450
Injection Pressure (max)*	MPa	239	183	162
	psi	34664	26542	23496
Plasticizing Rate (GPPS)	g/s	69.8	92	101
	oz./s	2.46	3.25	3.56
Plasticizing Rate (HDPE)	g/s	105.1	141.5	159.7
	oz./s	3.71	4.99	5.63
Screw Speed	rpm	220	220	220



# Specification



## JU5500V-3450

JUPITER 5 Series: Two-Platen Servo-Hydraulic

Other		
Pump Motor Power	kW	65
Heater Power	kW	39
Machine Dimension (LxWxH)	m	7.46×2.35×2.51
	in.	294×93×99
Machine Weight	t	22
	lbs.	48502
Hopper Capacity	kg	50
	lbs.	110
Oil Tank	l	430
	gal	114

\*NOTE:

1. Injection Pressure (max) uses the machine's regeneration oil circuit to increase the injection pressure. This function will reduce injection control and repeatability. The standard "Injection Pressure" specification is the maximum injection pressure in a normal operating mode.
2. Moving platen max mold weight is 2/3 of total max mold weight.
3. Electric screw drive (screw rotate) is standard for injection units under 11500. For injection units 11500 and above electric screw drive is optional.
4. Machine dimensions and weights are based on the international standard configuration and are for reference only. Any options or country specific requirements will affect this. Contact Absolute Haitian service department for machine specific information.
5. Power requirements are based on the international standard configuration and are for reference only. Any options or country specific requirements will affect this. Contact Absolute Haitian service department for machine specific information.

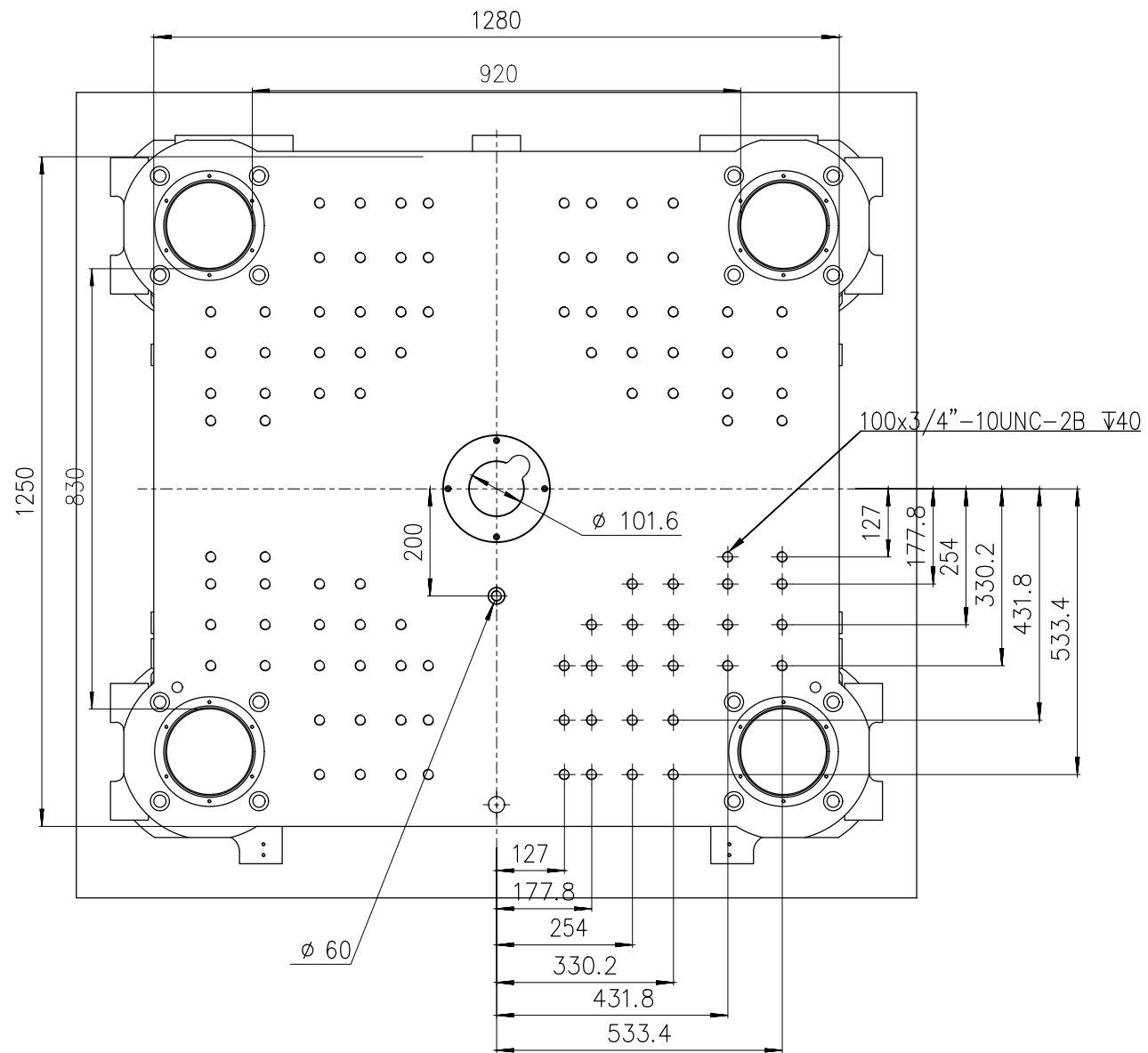

Fixed Platen

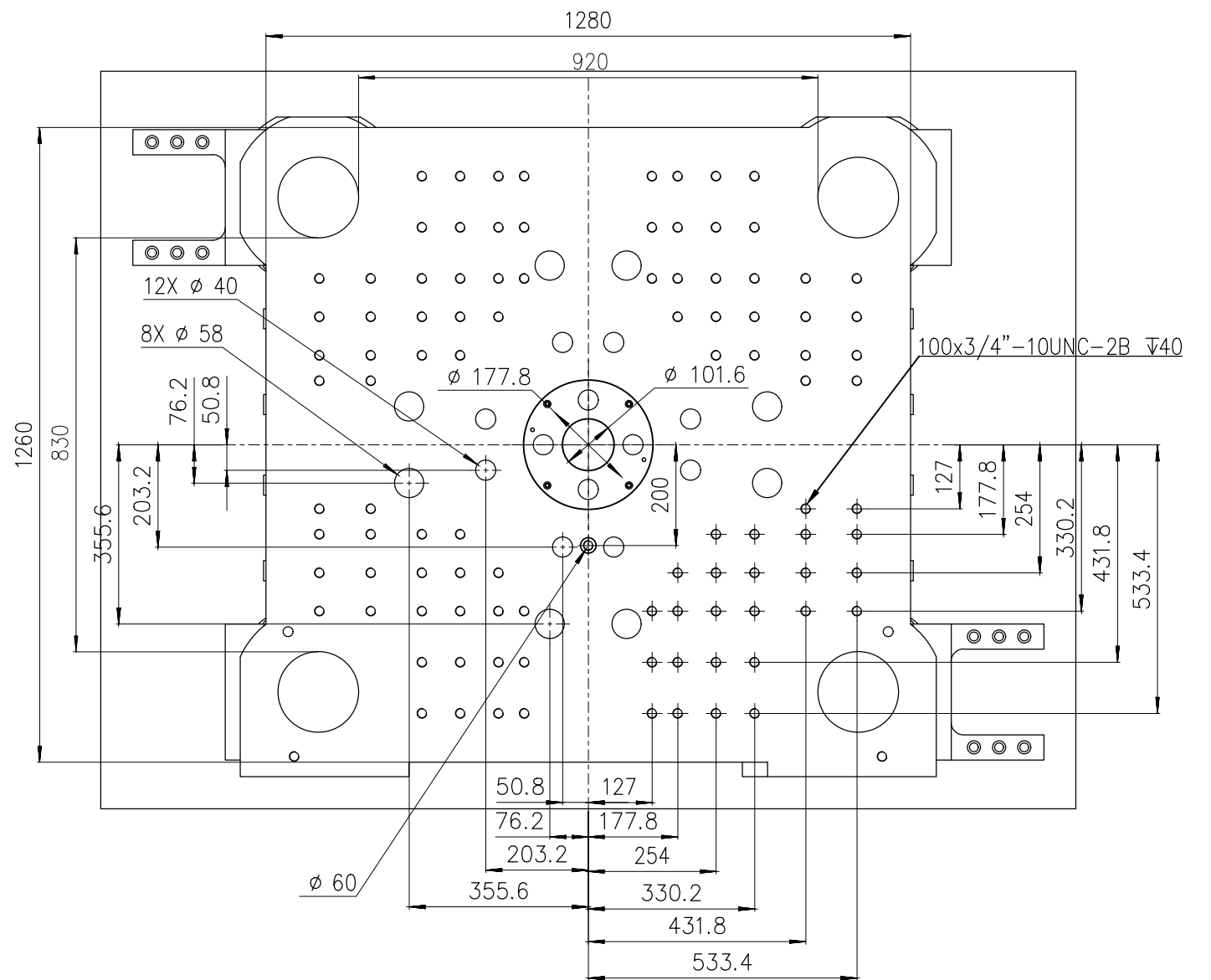

Moving Platen



Absolute Haitian Corporation  
33 Southgate St. Worcester, MA  
T: +1 508-792-4305  
www.absolutehaitian.com

Title: JUV 5500 Fixed & Moving Platens Drawing

Machine Model: JUV 5500  
Machine Serial Number:  
Machine Tonnage:

Sheet: 1 of 1

Drawn By: Harry Date: 1/9/2024  
Chkd By: LEON XIE Date: 1/9/2024

Revision	Date:	Drawing #:	NOT TO SCALE	Size: 11 X 17 "B"
Rev #: 1				Units: mm / [in]
Rev #: 2				Material:
Rev #: 3				Part:
Rev #: 4				Part:
Rev #: 5				Part:

PLEASE READ:

The designs on this drawing were validated using machine manufacturer's drawings and/or information supplied by Absolute or the customer. It is the responsibility of the customer to review and confirm that all dimensions are consistent with the application intended and in accordance with the facility requirements for space, part clearance, overhead clearance, or any other interference. By signing this document, the customer accepts full responsibility for this design and application.

Customer:

Customer Approval:  
Authorized Signature

Notes:

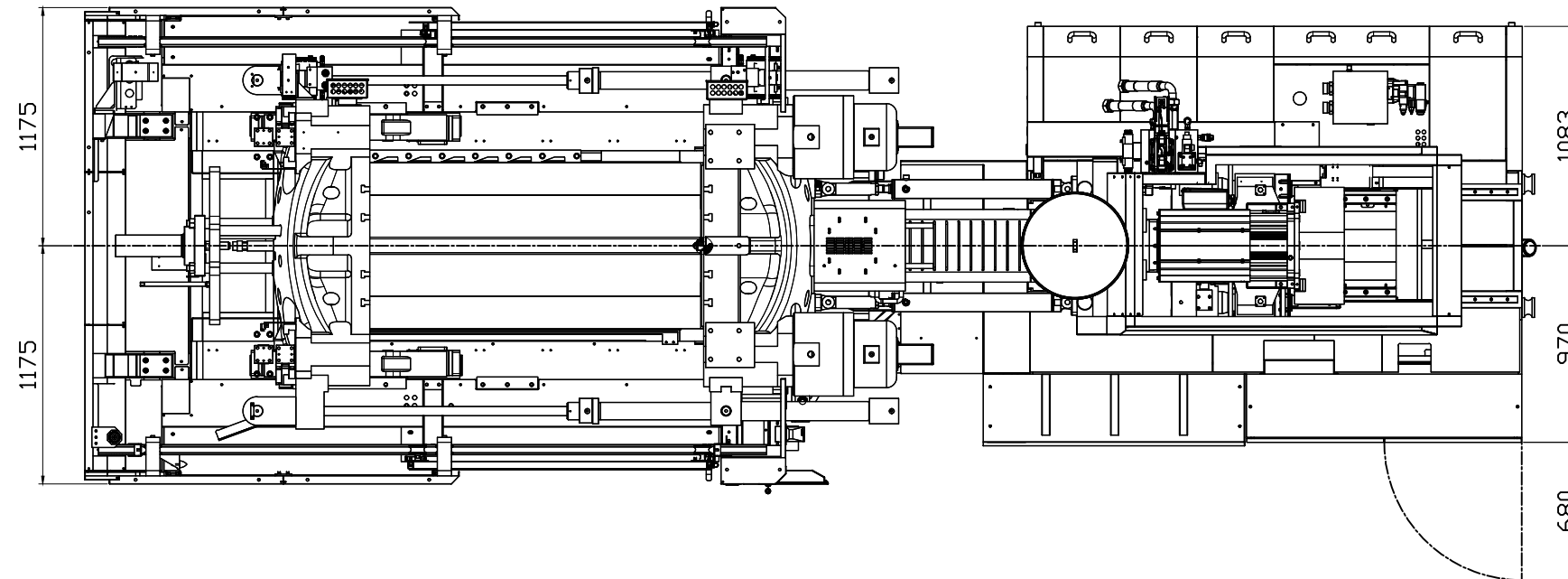
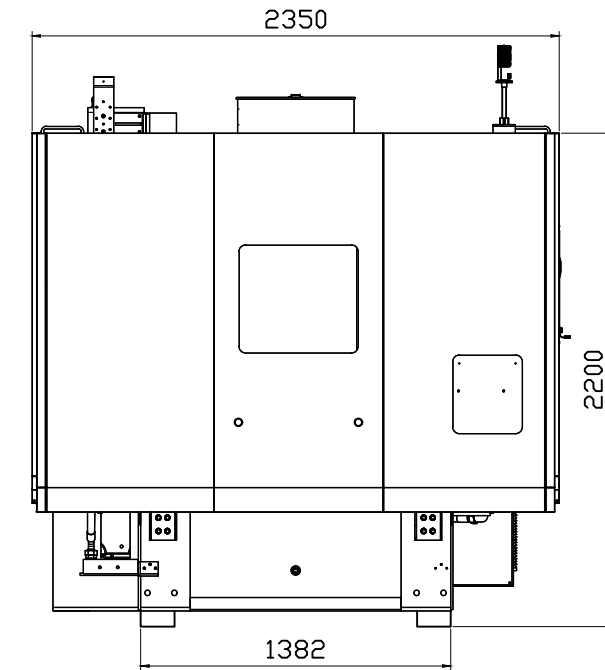
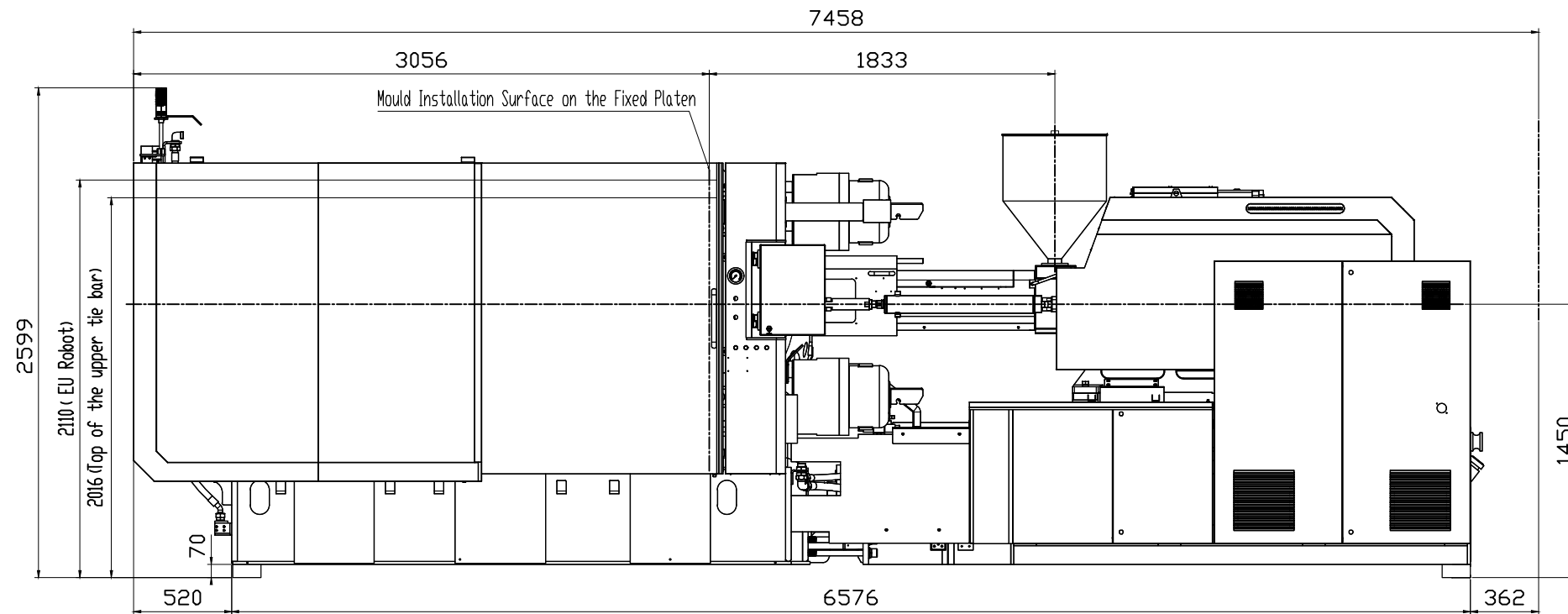

Absolute Haitian Corporation  
 33 Southgate St. Worcester, MA  
 T: +1 508-792-4305  
 www.absolutehaitian.com

Title: MA V 5500-3450 Layout Drawing

Machine Model: MA V 5500-3450  
 Machine Serial Number:  
 Machine Tonnage:

Revision	Date:	Drawing #: Layout
Rev #: 1		
Rev #: 2		
Rev #: 3		
Rev #: 4		
Rev #: 5		

Sheet: 1 of 1

Drawn By: Harry Date: 3/21/2024  
 Chkd By: LEON XIE Date: 3/21/2024  
 NOT TO SCALE Size: 11 X 17 "B"

Units: mm / [in]  
 Material:  
 Part:  
 Part:  
 Part:  
 Part:

PLEASE READ:

The designs on this drawing were validated using machine manufacturer's drawings and/or information supplied by Absolute or the customer. It is the responsibility of the customer to review and confirm that all dimensions are consistent with the application intended and in accordance with the facility requirements for space, part clearance, overhead clearance, or any other interference. By signing this document, the customer accepts full responsibility for this design and application.

Customer:

Customer Approval:  
 Authorized Signature

Notes:

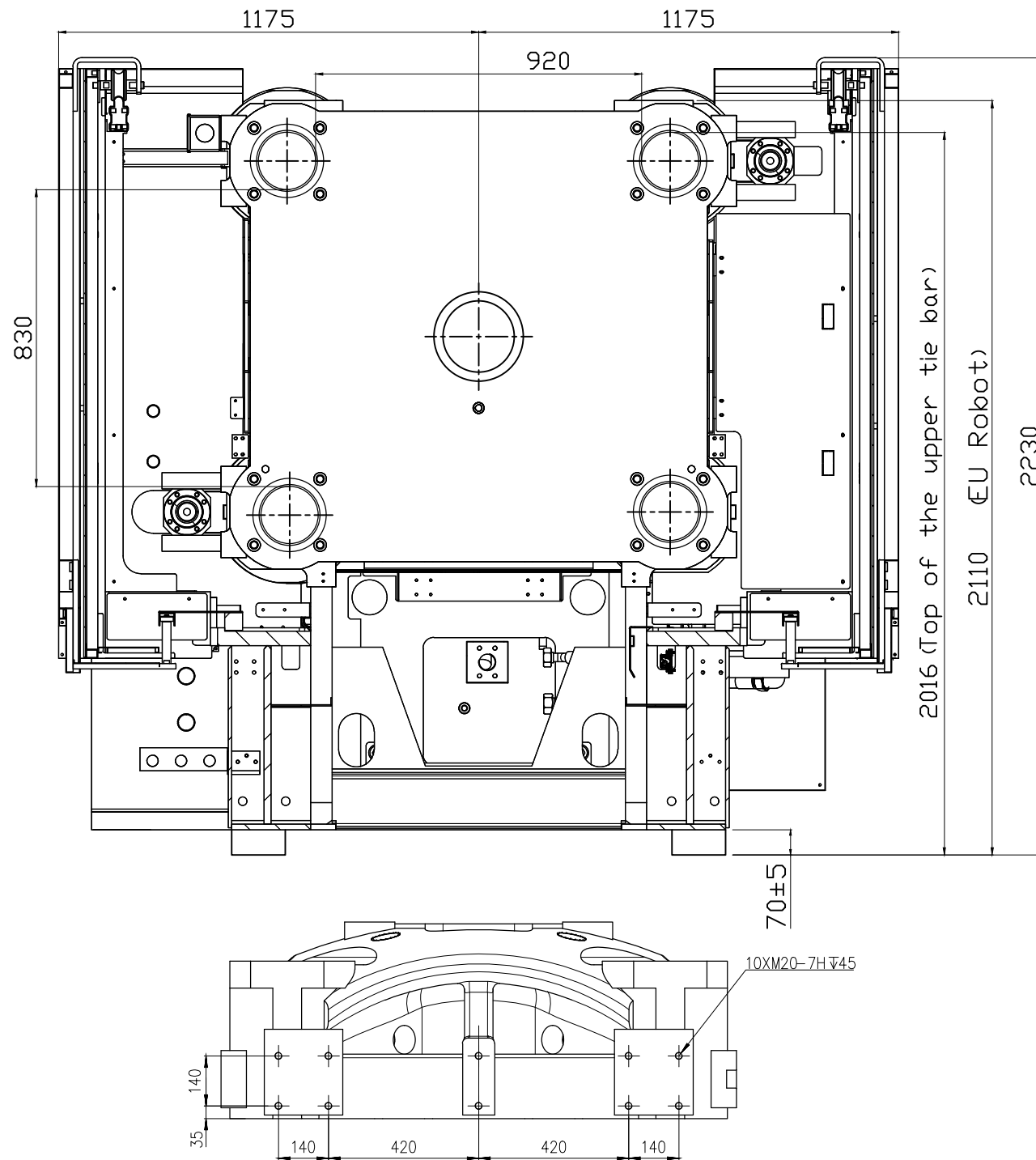

Absolute Haitian Corporation  
 33 Southgate St. Worcester, MA  
 T:+1 508-792-4305  
 www.absolutehaitian.com

Title: JU V 5500-3450 Robot Mounting Drawing

Machine Model: JU V 5500-3450  
 Machine Serial Number:  
 Machine Tonnage:

Sheet: 1 of 1

Drawn By: Harry Date: 4/9/2024  
 Chkd By: LEON XIE Date: 4/9/2024

Revision Date: Drawing #: Robot Mounting

Rev #: 1  
 Rev #: 2  
 Rev #: 3  
 Rev #: 4  
 Rev #: 5

NOT TO SCALE Size: 11 X 17 "B"

Units: mm / [in]

Material:  
 Part:  
 Part:  
 Part:  
 Part:

PLEASE READ:

The designs on this drawing were validated using machine manufacturer's drawings and/or information supplied by Absolute or the customer. It is the responsibility of the customer to review and confirm that all dimensions are consistent with the application intended and in accordance with the facility requirements for space, part clearance, overhead clearance, or any other interference. By signing this document, the customer accepts full responsibility for this design and application.

Customer:

Customer Approval:  
 Authorized Signature

Notes: